

# INSTALLATION INSTRUCTION

Item# 10426-732

READ AND SAVE THESE INSTRUCTIONS

**WARNING! SHUT POWER OFF AT FUSE OR CIRCUIT BREAKER .**  
**AVERTISSEMENT! COUPER LE COURANT AU NIVEAU DES FUSIBLES OU DU DISJONCTEUR.**

## PREPARATION

1. Shut off the power at the fuse box or circuit breaker. If necessary, remove the old fixture, including the mounting hardware.
2. Carefully unpack your new fixture and lay out all the parts on a clear area. Take care not to lose any parts necessary for installation.

## ASSEMBLING THE FIXTURE (Fig.1)

3. Place the nipple (K) over the tube (L) and tighten nipple in coupling (P).
4. Secure connector (O) of shade (N) on the round iron plate (Q) with screws (M).

## HANGING THE FIXTURE (Fig.2)

5. Thread all thread (E) into ceiling loop (H) until snug.
6. Thread hex nut (D) onto all thread (E). Place lock washer (C) over end of all thread (E).
7. Thread the other end of all thread (E) with the loop into crossbar (A) until snug. The length of all thread (E) into crossbar (A) may be adjusted if necessary.
8. Take crossbar (A) assembly and mount to ceiling junction box (Not included) with the mounting screws (B) (Size: #8-32\*0.6"L). The side of the crossbar marked "GND" must face out.
9. Using proper chain pliers open one link of chain (I) and connect it to the fixture loop (J). Then close the chain.
10. By measuring, determine connect number of links needed for desired hanging height.
11. Lace the fixture wires through the chain links and slip screw collar ring (G) and canopy (F) over the chain.
12. Open one link of the other end of the chain (I) and connect it to the ceiling loop (H). Then close the chain.
13. Feed the fixture wires through the ceiling loop (H) and all thread (E) and pull until taut.

## CONNECTING THE WIRES (Fig. 3)

14. Connect the electrical wires as shown in Fig.3. Making sure that all wire connectors are secured. If your junction box has a ground wire (green or bare copper), connect the ground wires to it. Otherwise, connect the ground wire directly to the crossbar (A) using green screw provided.
15. Tuck wire connections neatly inside the junction box.

## COMPLETING THE INSTALLATION (Fig. 1)

16. Raise canopy (F) to the ceiling. Raise the screw collar ring (G) and thread onto ceiling loop (H) protruding through canopy (F). (Fig.2)
17. Install (3) three medium base bulbs up to 100 watts each or CFL or LED equivalent (not included) in accordance with the fixture specification. **(DO NOT EXCEED THE SPECIFIED WATTAGE!)**  
**(NE PAS DEPASSER LA PUISSANCE NOMINALE MAXIMALE!)**
18. Thread the nipple (T) to coupling (R) and tighten it with hex nut (S).
19. Slide the glass shield (U) and the plastic washer(V) over the nipple(T), then secure with the bottom finial(W).

Your installation is now complete. Return the power to the junction box and test the fixture.

Fig.1

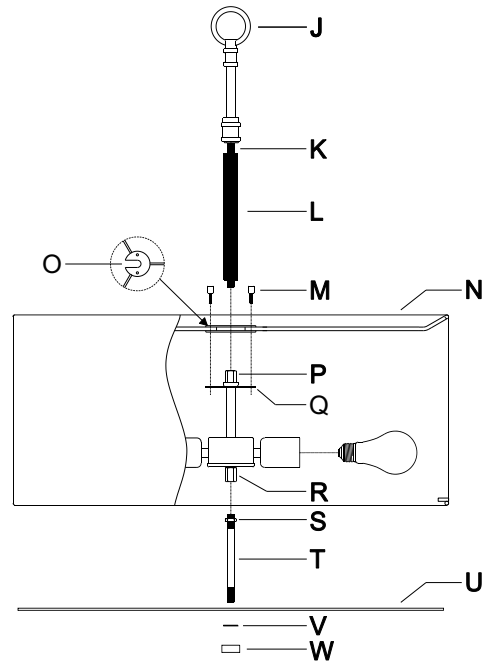

Fig.2

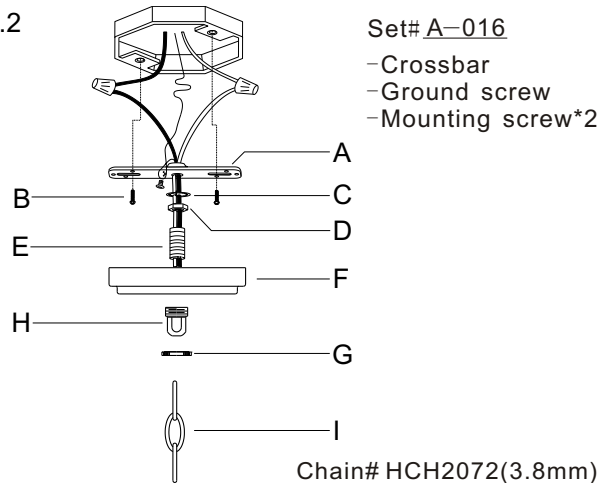
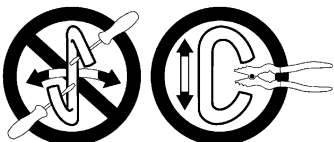
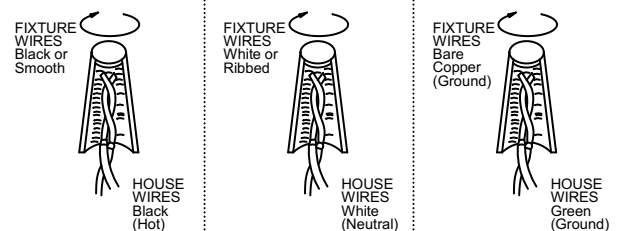

Fig.3



Notice: It is important to use proper chain pliers (not included) To OPEN and CLOSE the chain included with this fixture. Do not open them with other tools that may twist or stress the chain links. It is important to use proper chain pliers like the ones shown in the diagram.

