

INSTALLATION INSTRUCTIONS

Item#18752-XXX-L

READ AND SAVE THESE INSTRUCTIONS

WARNING! SHUT POWER OFF AT FUSE OR CIRCUIT BREAKER.

AVERTISSEMENT! COUPER LE COURANT AU NIVEAU DES FUSIBLES OU DU DISJONCTEUR.

MOUNTING THE FIXTURE (Fig.1)

1. Shut off the power at the circuit breaker and remove the old fixture, including the mounting hardware.
2. Carefully remove the fixture from the carton and check that all parts are included as shown in the illustration.
3. Remove screws (F) (Size:#8-32 0.5") from fixture body (G). Position the mounting plate (C) on the wall and mark the location of the two drywall anchors. Pre-drill the holes for the drywall anchors. Then insert the drywall anchors into wall.
4. Attach the mounting plate (C) to the junction box (Not included) using the mounting screws (E) (size: 8/32*25mm) and Anchor Screws (D). The side of the mounting plate (C) marked "GND" must face out.

CONNECTING THE WIRES (Fig. 2)

5. At this point, connect the electrical wires as shown in Fig. 2, making sure that all wire connectors are secured. If your outlet box has a ground wire (green or bare copper), connect the fixture's ground wire to it. Otherwise, connect the fixture's ground wire directly to the mounting plate using the green screw provided. After the wires are connected, tuck them carefully inside the junction box.

FINISHING THE INSTALLATION (Fig.1)

- 6 Place fixture body (G) over mounting plate (C) and fasten with screws (F).
- 7 Secure Glass (J) to arm (H) with Glass Screws (I). Do not over tighten.

Note: Illustration (Fig.1) on this manual is for installation purposes only. It may or may not be identical to the fixture purchased.

IMPORTANT: FIXTURE SHOULD BE INSTALLED BY A QUALIFIED ELECTRICIAN TO ENSURE PROPER WIRING AND INSTALLATION.

Dimmable with ELV and/or LED compatible wall dimmer switches.

Fig1

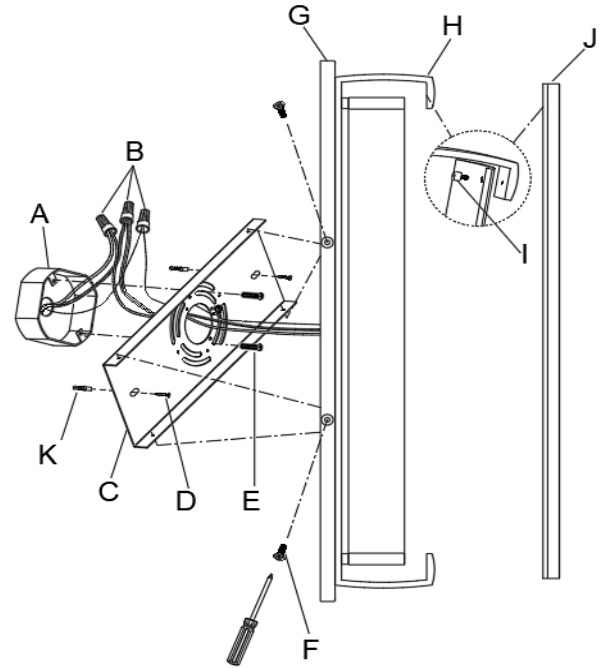

Set# A-
-Mounting Plate
-Ground Screw
-Mounting Screw*2

Fig. 2

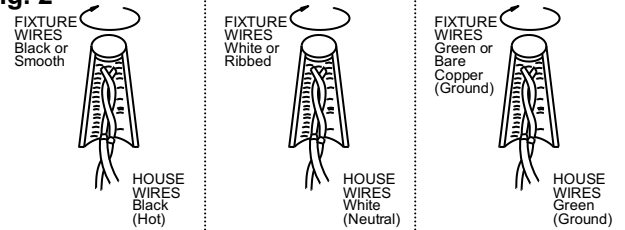

Your installation is now complete. Return power to the junction box and test the fixture.

