

# INSTALLATION INSTRUCTIONS

For Model 5971-1 U.S. Patent No: D588,304

This product is protected by United States Federal and/or State Law, including Patent and/or Copyright laws.

© Minka Lighting Inc.

READ AND SAVE THESE INSTRUCTIONS(06/27/2012)

**WARNING! SHUT POWER OFF AT FUSE OR CIRCUIT BREAKER.**

**AVERTISSEMENT! COUPER LE COURANT AU NIVEAU DES FUSIBLES OU DU DISJONCTEUR.**

## MOUNTING THE BACKPLATE (Fig.1)

1. Shut off the power at the circuit breaker and remove old fixture, including the crossbar.
2. Carefully unpack your new fixture and lay out all the parts on a clear area. Take care not to lose any small parts necessary for installation.
3. Place the square strap (A) onto the outlet box, the side of the square strap marked "GND" must face out, then secure the square strap (A) to the outlet box by threading the two outlet box screws (B) until snug.

## CONNECTING THE WIRES (Fig. 2)

1. At this point, connect the electrical wires as follow, Connect the black wire from the fixture to the black house (hot) wire. Connect the white wire from the fixture to the white (neutral) house wire. Make sure all wire nuts are secured. You may wrap the connections with electrical tape. If your outlet has a ground wire (green or bare copper) connects fixture's ground wire to it. Otherwise connect fixture's ground wire directly to the crossbar using the green screw provided.

## MOUNTING FIXTURE AND SHADE

1. After the wires are connected tuck them carefully inside the outlet box as you place the fixture base (D) onto the square strap (A). Adjust the hold of square strap (A) and the fixture base fit for the studs, and then secure the square strap (A) and fixture base (D) with Allen Screws (C) until snug using Wrench (I).
2. Place metal frame (H) and the glass shade (F) over the socket (E) and secure the glass shade with socket ring (G) tightly .
3. Install the bulb in accordance with the fixture's specification.

**(DO NOT EXCEED THE MAXIMUM WATTAGE RATING!!) (NE PAS DEPASSER LA PUISSANCE NOMINALE MAXIMALE!)**

Your installation is now complete. Return power to the junction box and test the fixture.

**Note: Illustration (Fig. 1) on this manual is for installation purposes only. It may or may not be identical to the fixture purchased.**

Fig.1

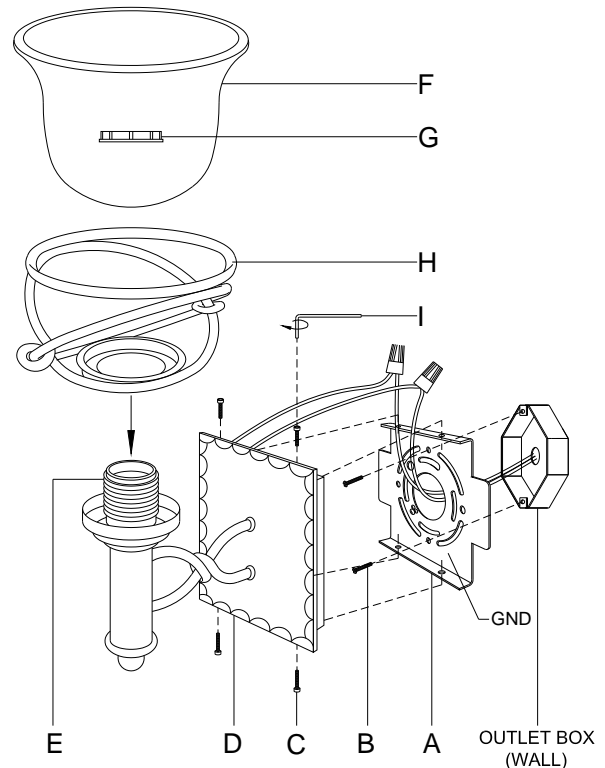
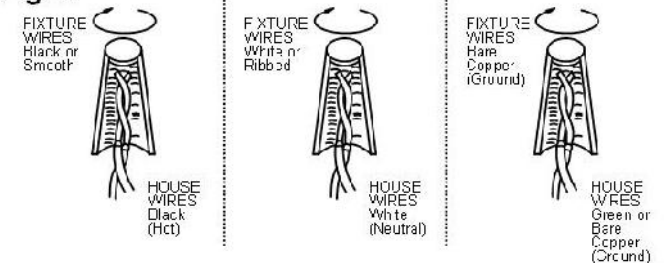

Fig. 2



american  
lighting  
association



LA-1835E