

INSTALLATION INSTRUCTION FOR 6360

For Wall Mount Light Fixtures

WARNING! SHUT POWER OFF AT FUSE OR CIRCUIT BREAKER .
AVERTISSEMENT! COUPER LE COURANT AU NIVEAU DES FUSIBLES OU DU DISJONCTEUR.

READ AND SAVE THESE INSTRUCTIONS

PREPARATION

1. Shut off the power at the fuse box or circuit breaker box. If necessary, remove the old fixture and all mounting hardware from wall junction box.
2. Carefully unpack your new fixture and lay out all the parts on a clear area. Take care not to loose any small parts necessary for installation.

MOUNTING THE FIXTURE (FIG.1)

3. Secure back plate (A) to outlet box (not provided) with outlet box screws (B) through slotted holes in back plate.

CONNECTING THE WIRES (Fig. 2)

4. Connect the fixture wires to the junction box wires as shown in Fig. 2. Make sure all wire connectors are secure and do not easily pull off with a slight tug. If there is no green ground wire from the junction box, connect the fixture ground wire to the circular strap or the crossbar with the green screw provided.
5. Tuck the wire connections neatly into the wall junction box.
6. Raise the face plate (C) to back plate (A), and secure the face plate(C) with screws (D) using wrench (E).

COMPLETING THE INSTALLATION

7. Install the proper light bulbs for your fixture.
(DO NOT EXCEED THE MAXIMUM WATTAGE RATING!) (NE PAS DEPASSER LA PUISSANCE NOMINALE MAXIMALE!)
8. Place the inner glass (I) over the socket (H) and onto the spinning (G), then place the outer glass (J) over the inner glass (I) and onto larger spinning (F).

Return the power to the junction box and test the fixture. Your installation is now complete.

Fig.1

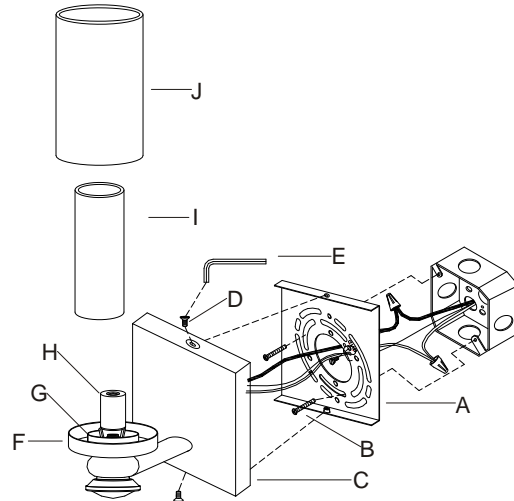

Fig.2

