

# INSTALLATION INSTRUCTION FOR 6954

## For Wall Mount Light Fixtures

**WARNING! SHUT POWER OFF AT FUSE OR CIRCUIT BREAKER .**  
**AVERTISSEMENT! COUPER LE COURANT AU NIVEAU DES FUSIBLES OU DU DISJONCTEUR.**

READ AND SAVE THESE INSTRUCTIONS

### PREPARATION

1. Shut off the power at the circuit breaker and remove the old fixture, including the mounting hardware.
2. Carefully remove the fixture from the carton and check that all parts are included as shown in the illustration.

### MOUNTING THE FIXTURE (Fig.1)

3. Secure circular strap (A) to outlet box with the junction box screws (B) (Size: #8-32\*0.6"L) through the slotted holes in the circular strap (A). The side of the circular strap (A) marked "GND" must face out.

### CONNECTING THE WIRES (Fig. 2)

4. At this point, connect the electrical wires as shown in Fig. 2 making sure all wire connectors are secured. If your outlet box has a ground wire (green or bare copper) connect fixture's ground wire to it. Other wise, connect the fixture's ground wire directly to the mounting plate using the green screw provided. After the wires are connected, tuck them neatly inside the junction box.

### COMPLETING THE INSTALLATION

5. Mount the fixture body (D) to the circular strap (A), and then secure with the mounting screws (C) (Size: #8-32\*0.5"L).
6. Place the glasses (F) and the cups (G) over the sockets (E), then secure with the socket rings (H) with the wrench (I) provided.
7. Install the light bulbs in accordance with the fixture's specifications (**DO NOT EXCEED THE MAXIMUM WATTAGE!**) (**NE PAS DEPASSER LA PUISSANCE NOMINALE MAXIMALE!**)

Your installation is now complete. Return the power to the junction box and test the fixture.

Fig.1

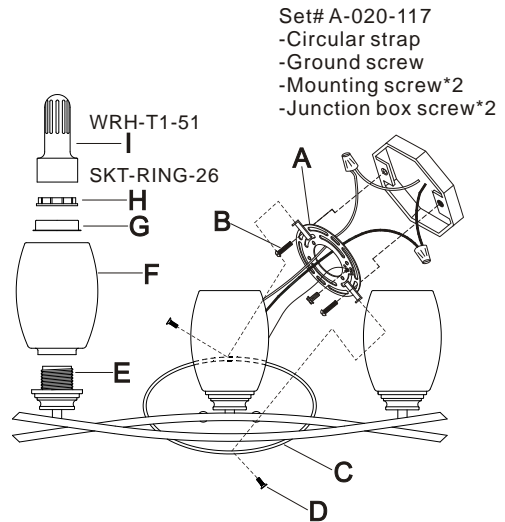

Fig.2

