

INSTALLATION INSTRUCTION

Item#72440-291 (New. 03/14/2015)

READ AND SAVE THESE INSTRUCTIONS

WARNING! SHUT POWER OFF AT FUSE OR CIRCUIT BREAKER.

AVERTISSEMENT! COUPER LE COURANT AU NIVEAU DES FUSIBLES OU DU DISJONCTEUR.

PREPARATION (Fig. 1)

1. Shut off power at the fuse box or circuit breaker box. If necessary, remove the old fixture including the mounting hardware.
2. Carefully unpack your new fixture and lay out all the parts on a clear area. Take care not to lose any small parts necessary for installation.
3. Attach circular strap (A) to the outlet box using mounting screws (B) (Size: #8-32N*L0.5"). The side of the circular strap marked "GND" must face out.
4. Thread studs (C) into the pre-drilled holes of circular strap (A) spaced the same distance apart as the holes in the back plate of the fixture body (D). The length of studs (C) into circular strap (A) may be adjusted if necessary.

CONNECTING THE WIRES (Fig. 2)

5. At this point, connect the electrical wires as shown in Fig. 2, making sure that all wire connectors are secured. If your outlet box has a ground wire (green or bare copper), connect the fixture's ground wire to it. Otherwise, connect the fixture's ground wire directly to the circular strap using the green screw provided. After wires are connected, tuck them carefully inside the outlet box.

COMPLETING THE INSTALLATION (Fig. 1)

1. Align fixture body (D) onto studs (C) and secure with knurled knobs (E).
2. To prevent moisture from entering the outlet box and causing a short, use clear caulking (i.e. Indoor/Outdoor Silicone Sealant) to outline the outside of fixture back-plate where it meets the wall leaving a space at bottom to allow moisture a means to escape (Fig.3).
3. Bulb (I) information: (1 X AC LED 14W included). **(DO NOT EXCEED THE SPECIFIED WATTAGE!) (NE PAS DEPASSER LA PUISSANCE NOMINALE MAXIMALE!).**

REPLACING LED MODULE (Fig.4)

The LED module can be replaced by a qualified electrician without cutting of wire and without damage to any decorative element to which the fixture is attached. See installation steps for more details (Fig.4)

- a. Shut off the power, use a screw driver to loosen screws (Q) and remove the metal frame with shade (P) from top cover (S).
- b. Use a screw driver to loosen the module screws (O) and remove the LED module (L) and glass (M) from the white plastic ring (N).
- c. Un-plug the wire quick connectors and remove LED module (N) for re-lamping. (Note: The LED module should be provided by specified supplier).
- d. For better heat dissipation the LED module (N) should be installed with the heat transfer material (K) when re-lamping.

Your installation is now complete. Return the power to the junction box and test the fixture.

Note: Illustration (Fig. 1) on this manual is for installation purposes only. It may or may not be identical to the fixture purchased.

Fig. 1

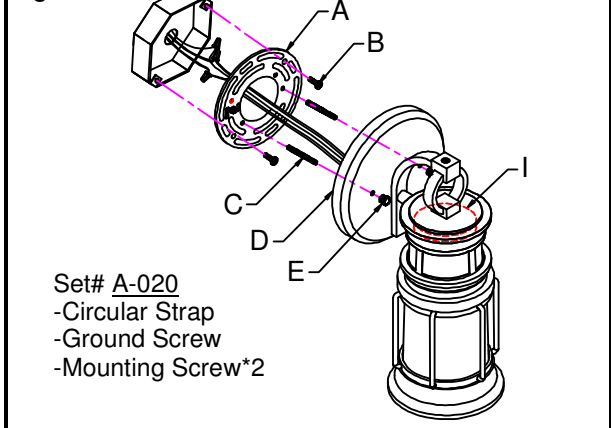

Fig. 2

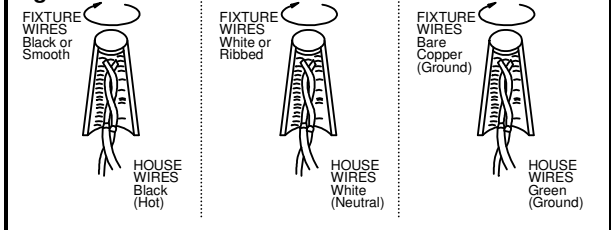

Fig. 3

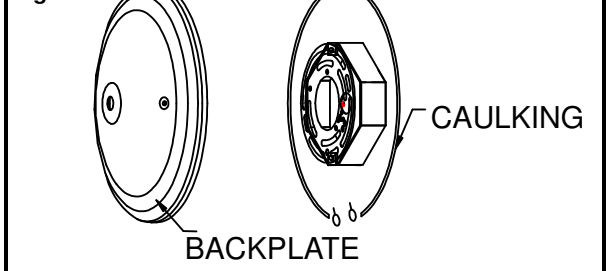
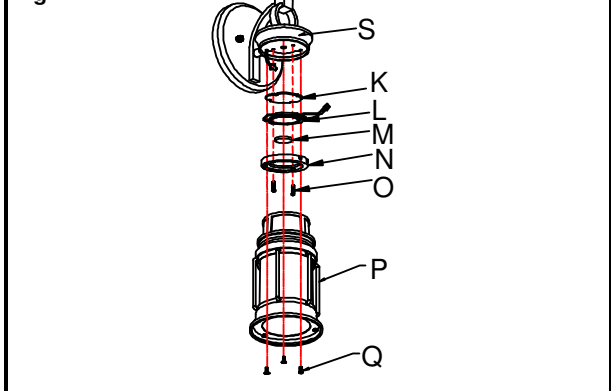

Fig. 4



LA-2460E



american
lighting
association