

# INSTALLATION INSTRUCTIONS

Item#8106-A138-L (Rev. 04/29/2013)

## READ AND SAVE THESE INSTRUCTIONS

**WARNING! SHUT POWER OFF AT FUSE OR CIRCUIT BREAKER.**  
**AVERTISSEMENT! COUPER LE COURANT AU NIVEAU DES FUSIBLES OU DU DISJONCTEUR.**

1. Shut off power at the circuit breaker and remove old fixture including the mounting hardware.
2. Carefully unpack your new fixture and lay out all the parts on a clear area. Take care not to lose any small parts necessary for installation.
3. Pull the black, white and ground wires out of post (C).
4. Next, connect electrical wires while supporting the lantern as shown in (Fig.2). If your outlet has a ground wire (green or bare copper), connect the fixture ground wire to it. If not, consult your electrician for proper grounding. After wires are connected, tuck them carefully inside the post. Align the lantern with post and secure Bottom Assembly (A) with Sheet Metal Screws (B) (Fig.1 & 2).
5. Bulb (D) information: (1 X AC LED 10W included.) **(DO NOT EXCEED THE MAXIMUM WATTAGE RATING!!) (NE PAS DEPASSER LA PUISSANCE NOMINALE MAXIMALE!)**

Fig. 1

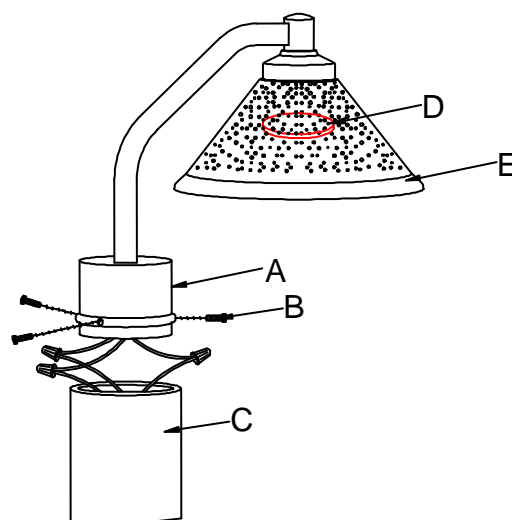

### REPLACING LED MODULE (Fig.3)

The LED module can be replaced by a qualified electrician without cutting of wire and without damage to any decorative element to which the fixture is attached. See installation steps for more details (Fig.3)

- a. Shut off the power, use a screw driver to loosen the screws (Q) and remove the glass shield (P) from the aluminum cover (E).
- b. Loosen the module screws (O) and remove the LED module (L) and glass (M) from the white plastic ring (N).
- c. Loosen screws (J) to remove aluminum plate (I) and aluminum cover (F) from the bracket (G).
- d. Remove wire connectors (H) to disconnect the LED for re-lamping. (Note: The LED module should be provided by specified supplier.)
- e. For better heat dissipation the LED module (L) should be installed with the heat transfer material (K) when re-lamping.

Your installation is now complete. Return power to the junction box and test the fixture.

**Note:** Illustration (Fig.1) on this manual is for installation purposes only. It may or may not be identical to the fixture purchased.

Fig. 2

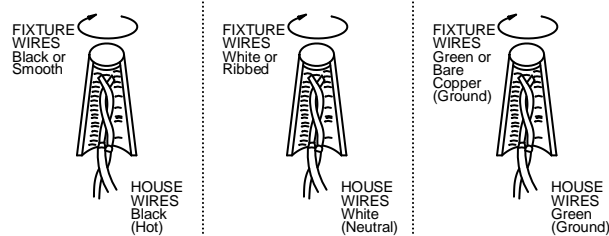
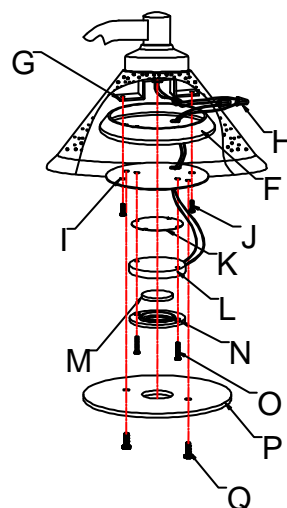

Fig. 3



LA-2273E



american  
lighting  
association