

# INSTALLATION INSTRUCTIONS

For Model 8136-L

READ AND SAVE THESE INSTRUCTIONS

**WARNING! SHUT POWER OFF AT FUSE OR CIRCUIT BREAKER.**

**AVERTISSEMENT! COUPER LE COURANT AU NIVEAU DES FUSIBLES OU DU DISJONCTEUR.**

## HANGING THE FIXTURE (Fig. 1)

1. Shut off the power at the circuit breaker and remove the old fixture.
2. Carefully unpack your new fixture and lay out all the parts on a clear area. Take care not to lose any small parts necessary for installation.

## 3. CONNECTING THE WIRES (Fig. 2)

At this point, connect the electrical wires as follows:

Connect the black wire from the fixture to the black (hot) wire.

Connect the white wire from the fixture to the white (neutral) wire.

Make sure all wire nuts are secured. Connections may be wrapped with electrical tape if necessary. If your outlet has a ground wire (green or bare copper), connect fixture's ground wire to it. Otherwise, connect fixture's ground wire directly to the crossbar using the green screw provided. Tuck the wire connections neatly into the post.

4. 5. Align fixture (A) to post (E) and secure with the 3 mounting screws (D).
5. Twist glass (C) into fixture (A)
6. Bulb (T) information: (1 x AC LED 14W included.)

**DO NOT EXCEED THE MAXIMUM WATTAGE RATING! (NE PAS DEPASSER LA PUISSANCE NOMINALE MAXIMALE!)**

## Replacing LED module (Fig. 3)

The LED module can be replaced by a qualified electrician without cutting of wire and without damage to any decorative element to which the fixture is attached. See installation steps for more details (Fig 3.)

- a. Shut off the power at the circuit breaker.
- b. Twist off glass (C) (Fig.1). Remove heat sink (P) by loosening screws (U).
- c. Remove connectors (O). Remove LED module (T) by loosening screws (R). Note: The LED module should be provided by a specified supplier.
- d. For better heat dissipation the LED module (T) should be installed with the heat transfer material (V) when re-lamping.

**Your installation is now complete. Return power to the junction box and test the fixture**

Fig.1

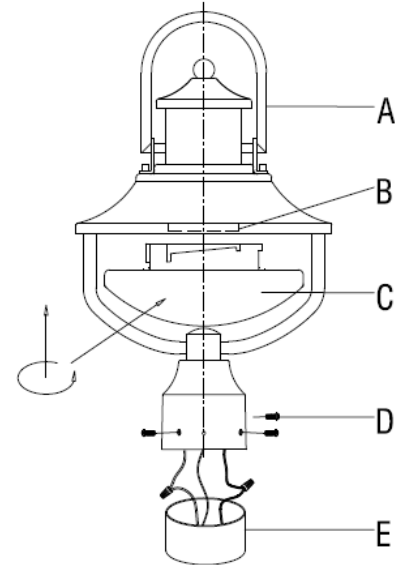

Fig. 2

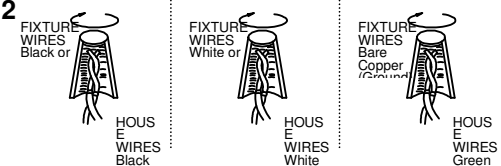

Fig.3

