

INSTALLATION INSTRUCTIONS

Item#840-102/249-L (New. 10/17/2018)

READ AND SAVE THESE INSTRUCTIONS

WARNING! SHUT POWER OFF AT FUSE OR CIRCUIT BREAKER.

AVERTISSEMENT! COUPER LE COURANT AU NIVEAU DES FUSIBLES OU DU DISJONCTEUR.

HANGING THE FIXTURE (Fig. 1)

1. Carefully remove the fixture from the carton and check that all parts are included as shown in the illustration.
2. Shut off power at the circuit breaker and remove the old fixture including the mounting hardware.
3. Position the mounting plate (C) on the ceiling and mark the location of the three drywall anchors (A). Pre-drill the holes for the drywall anchors (A). Then insert the drywall anchors (A) into the ceiling.
4. Thread mounting screws (B) into the pre-drilled holes in mounting plate (C). Spaced the same distance apart as the holes in the ceiling pan (I) and secure with hex nut (D).
5. Attach mounting plate (C) to the outlet box using mounting screws (F) (Size: #8-32N*L0.5") and wood screws (E) into drywall anchors (A). The side of the mounting plate marked "GND" must face out.

CONNECTING THE WIRES (Fig. 2)

6. At this point, connect the electrical wires as shown in Fig. 2, making sure that all wire connectors are secured. If your outlet box has a ground wire (green or bare copper), connect the fixture's ground wire to it. Otherwise, connect the fixture's ground wire directly to the mounting plate using the green screw provided. After wires are connected, tuck them carefully inside the junction box.

COMPLETING THE INSTALLATION (Fig. 1)

7. Place the ceiling pan (I) onto the mounting screws (B) and secure with the cap nuts (H).
8. Thread the nipple (K) to coupling (G) and tighten with hex nut (J).
9. Through glass shade (L), plastic washer (O) and metal washer (P) into the nipple (K) and secure part (R) by using the wrench (Q) (Not over tighten).
10. Secure finial (M) into the part (R).

Your installation is now complete. Return power to the junction box and test the fixture.

CAUTION/ATTENTION: When handling the fixture, do not apply pressure to the LEDs. Hold the fixture by the base or ceiling pan (I) only.

Replacing LED module (Fig.3)

The LED module can be replaced by a qualified electrician without cutting the wires and without damaging the decorative element to which the fixture is attached. See installation steps for more details (Fig.3)

Warning: Turn off power at the fuse box or circuit breaker before replacing the LED module.

- a. Loosen finial (M) and remove the part (R) by using the wrench (Q), then remove the metal washer (P), plastic washer (O) and glass shade (L).
- b. To remove the fixture from the ceiling: loosen the cap nuts (H) and remove the wire connectors. Then place the fixture on a clear flat surface (Fig.3).
- c. Loosen screws (T), then carefully remove the LED module (N) from ceiling pan (I).
- d. Use a pin to press from the hole of the quick connector and disconnect the black/white wire respectively.
- e. Reverse steps a-d for installing the new LED module.

Note: The LED module should be provided by a specified supplier.

Fig.1

Set#A-020-378

- Mounting Plate
- Ground Screw
- Mounting Screw*2

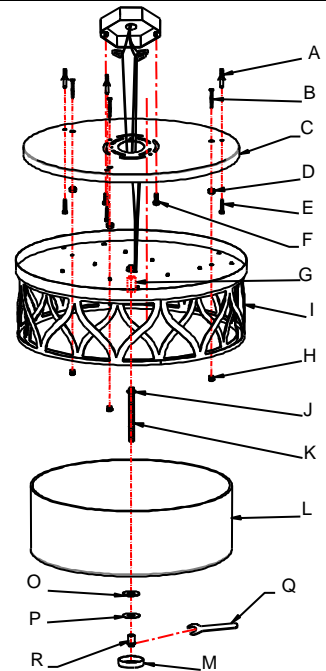

Wrench#WRH-Y-89

Fig. 2

FIXTURE WIRES
Black or
Smooth



HOUSE WIRES
Black
(Hot)

FIXTURE WIRES
White or
Ribbed



HOUSE WIRES
White
(Neutral)

FIXTURE WIRES
Bare
Copper
(Ground)

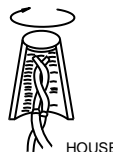

HOUSE WIRES
Green
(Ground)

Fig. 3

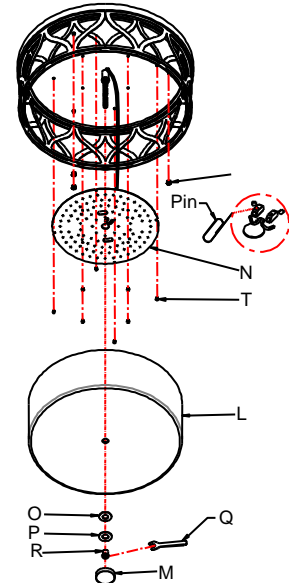

IMPORTANT: Fixture should be installed by a qualified electrician to ensure proper wiring and installation.

Dimmable with ELV and/or LED compatible wall dimmer switches.

LA-3015E

