

INSTALLATION INSTRUCTIONS

Item# N5624-732

READ AND SAVE THESE INSTRUCTIONS

WARNING! SHUT POWER OFF AT FUSE OR CIRCUIT BREAKER.
AVERTISSEMENT! COUPER LE COURANT AU NIVEAU DES FUSIBLES OU DU DISJONCTEUR.

HANGING THE FIXTURE (Fig. 1)

1. Shut off power at the fuse box or circuit breaker box and remove the old fixture including the mounting hardware.
2. Carefully unpack your new fixture and lay out all the parts in a clear area. Take care not to misplace any small parts necessary for installation.
3. Position mounting plate (B) on the ceiling and mark location of the three mounting holes. Pre-drill the holes for plastic anchors (A). Insert plastic anchors (A) into ceiling.
4. Attach mounting plate (B) to junction box (Not included) using outlet box screws (C) and mounting screws (E). The side of mounting plate marked "GND" must face out.
5. The support cable (K) is provided to support the weight of the fixture while wiring. Align the fixture to canopy (F) and attach hook on the end of support cable into a slot located on junction box. Carefully allow support cable to support the weight of the fixture while wiring (Fig.1).

CONNECTING THE WIRES (Fig. 2)

6. Connect the electrical wires as shown in (Fig.2), making sure that all wire connectors are secured. If your junction box has a ground wire (green or bare copper), connect the fixture ground wire to it. Otherwise, connect fixture ground wire directly to **mounting plate (B)** using green screw provided.
7. After wires are connected, tuck them carefully inside junction box.

FINISH THE INSTALLATION (Fig. 1)

8. Attach canopy (F) to mounting plate (B) and tighten with canopy screw (I).
9. Install (3) three medium base bulbs (G) up to 40 watts or LED equivalent (not included) in accordance with the fixture's specification.
DO NOT EXCEED THE MAXIMUM WATTAGE RATING! (NE PAS DEPASSER LA PUISSANCE NOMINALE MAXIMALE!).
10. In the final step, begin by securely hanging part (J1) onto the canopy hook as illustrated. Once this is properly positioned, carefully hang part (J2), ensuring it is firmly in place.

Your installation is complete now. Return power to the junction box and test the fixture.

Fig 1.

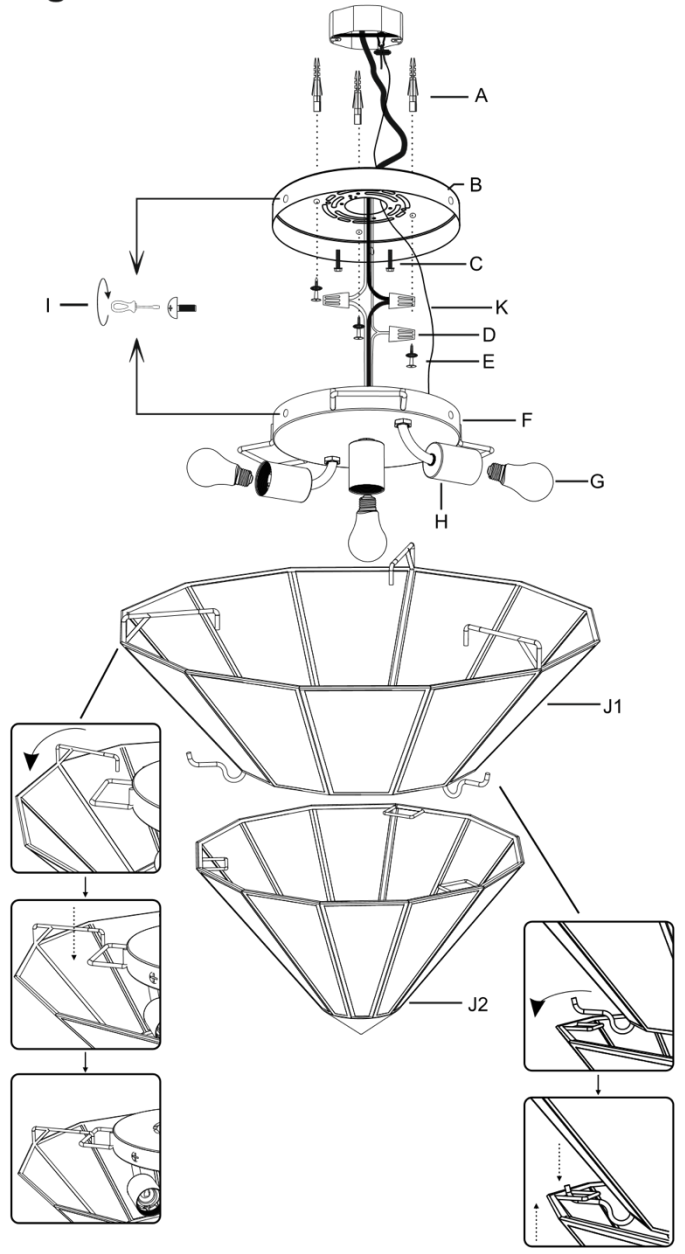

Note: Illustration (Fig.1) on this manual is for installation purposes only. It may or may not be identical to the fixture purchased.

IMPORTANT: FIXTURE SHOULD BE INSTALLED BY A QUALIFIED ELECTRICIAN TO ENSURE PROPER WIRING AND INSTALLATION.

Fig.2

