

INSTALLATION INSTRUCTIONS

Item#N7735-613 (New. 4/23/2021)

READ AND SAVE THESE INSTRUCTIONS

WARNING! SHUT POWER OFF AT FUSE OR CIRCUIT BREAKER.

AVERTISSEMENT! COUPER LE COURANT AU NIVEAU DES FUSIBLES OU DU DISJONCTEUR.

PREPARATION (Fig. 1)

1. Shut off power at the fuse box or circuit breaker box and remove the old fixture including the mounting hardware.
2. Carefully unpack your new fixture and lay out all the parts in a clean area. Take care not to misplace any small parts necessary for installation.

ASSEMBLING THE FIXTURE WITH CHAIN LOOP (Fig. 1&Fig.

3. Remove decorative nuts (E2) on socket assembly (M). Pass threaded rods (L) through holes on frame holder (I). Secure with decorative nuts (E2 and hand tighten until snug.
4. Secure metal tube (H) on all thread (K) of fixture body.
5. Determine desired hanging height and thread rods (G1, G2 and G3) onto all thread of metal tube (H). Attach swivel (F) by threading onto rod (G1). Pass wires carefully through each rod as you assemble.
6. Thread fixture body, rods and canopy (D) together. Hand tighten until snug.
7. Thread screws (A) into pre-drilled holes in mounting plate (B) spaced same distance apart as holes in canopy (D). The length of screws (A) may be adjusted if necessary. Then tighten with washer and hex nut screw (A).
8. Attach mounting plate (B) to junction box (Not included) using mounting screws (C) (Size: #8-32N*L1"). The side of mounting plate marked "GND" must face out.

CONNECTING THE WIRES (Fig. 3)

9. Connect electrical wires as shown in fig 3, making sure all wire connectors are secured. If your junction box has a ground wire (green or bare copper), connect the fixture's ground wire to it. Otherwise, connect the fixture's ground wire directly to the mounting plate (B) using green screw provided.
10. Tuck wire connectors neatly into junction box.

COMPLETING THE INSTALLATION (Fig. 1)

11. Place canopy (D) over screws (A), and secure with knurled knobs (E1).
12. Install (5) five candelabra base bulbs (O) up to 60 watts each or CFL or LED equivalent (not included) in accordance with the fixture specification—**DO NOT EXCEED THE MAXIMUM WATTAGE RATING! (NE PAS DEPASSER LA PUISSANCE NOMINALE MAXIMALE!)**.
13. Assemble glass (J) (6pcs per string), then hang it on hooks (P) of frame holder (I).

Your installation is now complete. Return power to the junction box and test the fixture.

Note: Illustration (Fig. 1) on this manual is for installation purposes only. It may or may not be identical to the fixture purchased.

Fig. 1

Set# A-020-A

-Circular Strap

-Ground Screw

-Mounting Screw*2

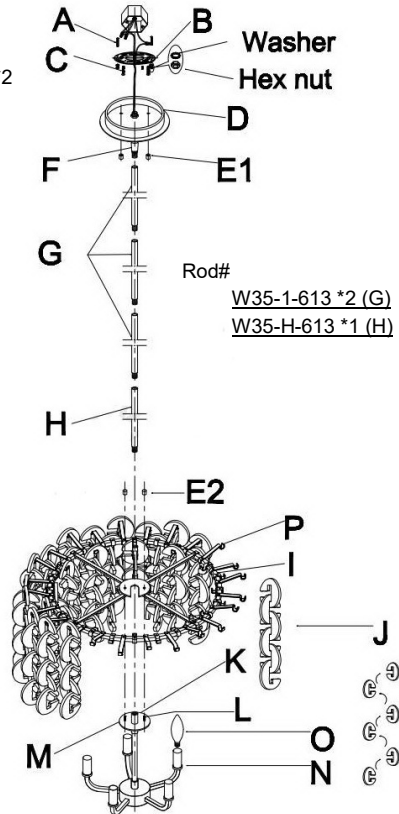

Rod#

W35-1-613 *2 (G)

W35-H-613 *1 (H)

Glass panel# GL7735

Candle Cover# CCV21050P-613

Fig. 3

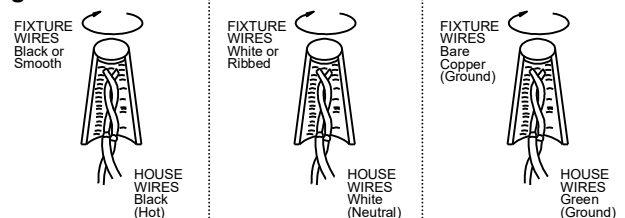

american
lighting

Fig.2

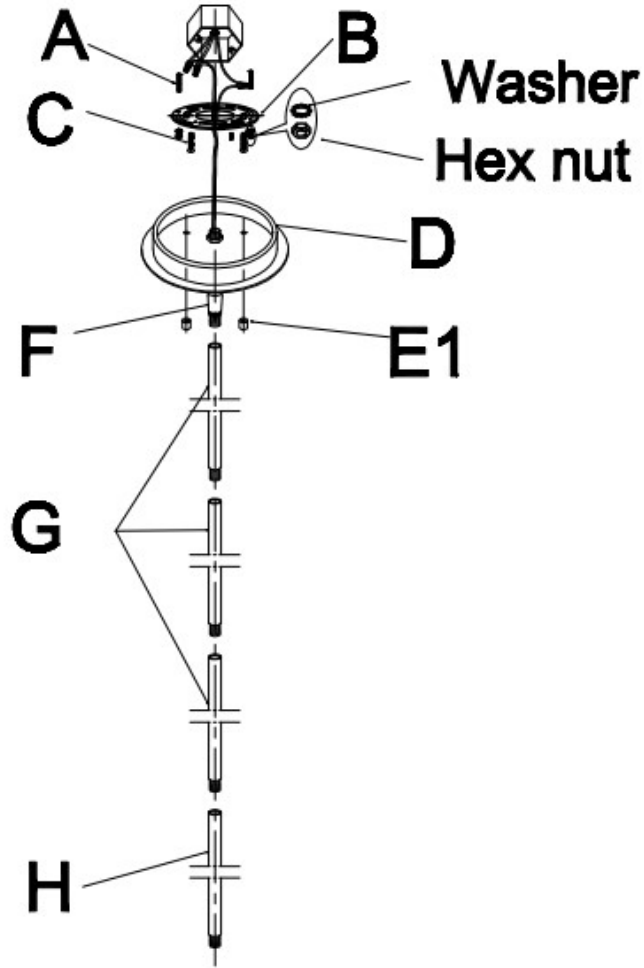

a. Hardware Bag:

- A. Screw *2
- B. Circular Strap *1
- C. Mounting Screw *2
- D. Canopy *1
- E1. Knurled Knob *2

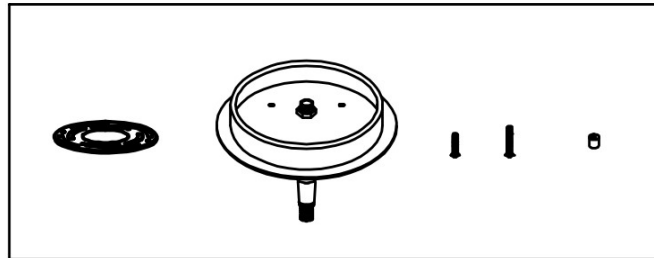

b. Hardware Bag:

- G. Rod 12" *3
- H. Rod 6" *1

