

Installation Instruction

For Table Lamp

Model#P1665-66A-L

Model#P1665-695-L

WARNING

- Risk of shock, do not plug in the unit before assembly is complete.
- Do not exceed the maximum wattage rating.
(Ne pas dépasser la puissance nominale maximale!)
- Before turning on, please follow the instruction manual step by step.

INSTALLATION

1. Carefully unpack your new lamp and place all parts on a smooth, flat surface to protect the finish until ready to install.
2. Vertically connect the tube to the lamp shade, rotating clockwise until lock tightly.
3. Vertically connect the tube to the base, rotating clockwise until lock tightly.
4. Installation is complete. Please follow below instructions before turning on the lamp.

CHARGING INSTRUCTIONS

This is a rechargeable lamp, there are 2pcs 1800mA lithium batteries inside the shade. Please use a Max 5V 3A charger to charge the product for the first time.

1. Charging: Please use standard Max 5V 3A charger. Insert the Type C charging cable directly into the charging interface at the bottom of the lamp shade.
2. Note: When charging, the power indicator on the lamp shade lights up in red and turns off when fully charged.
3. Remove the charger and Type C charging cable once fully charged.

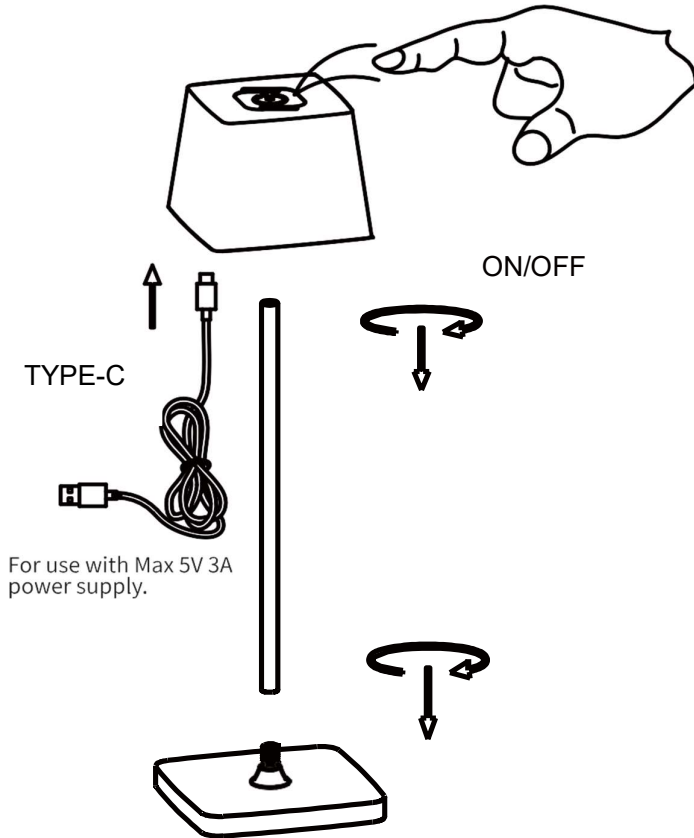

FUNCTIONAL DESCRIPTION

This lamp has a touch switch on the top of lamp shade.

1. A long touch (> 0.5 sec.): Light adjustment from 100% to 20% and vice versa.
2. A short touch (<0.5 sec.): ON/OFF
3. This switch has an auto-resume feature when power on, it will stay at the same brightness as the last time it was turn off.

IMPORTANT SAFETY INSTRUCTIONS

- Never use with and extension cord unless the plug can be fully inserted
- Do not change or alter
- It is strictly forbidden to dispose of this equipment with ordinary trash, it must be recycled.
- The product shall not be treated as regular trash, and must be delivered to a recycling center that is capable of recycling electronic and electrical equipment.
- Battery disposal should be compliance with local regulations that address the disposal of hazardous materials.
- Do not incinerate.

MADE IN CHINA

**IMPORTANT: FIXTURE SHOULD BE INSTALLED BY
A QUALIFIED ELECTRICIAN TO ENSURE PROPER
WIRING AND INSTALLATION.**

